

KOLB LAND CONSULTING, INC.
LAND SURVEYING • SUBDIVIDING • LAND PLANNING

LAKE GENEVA, WISCONSIN 53147

WHITEWATER, WISCONSIN 53190

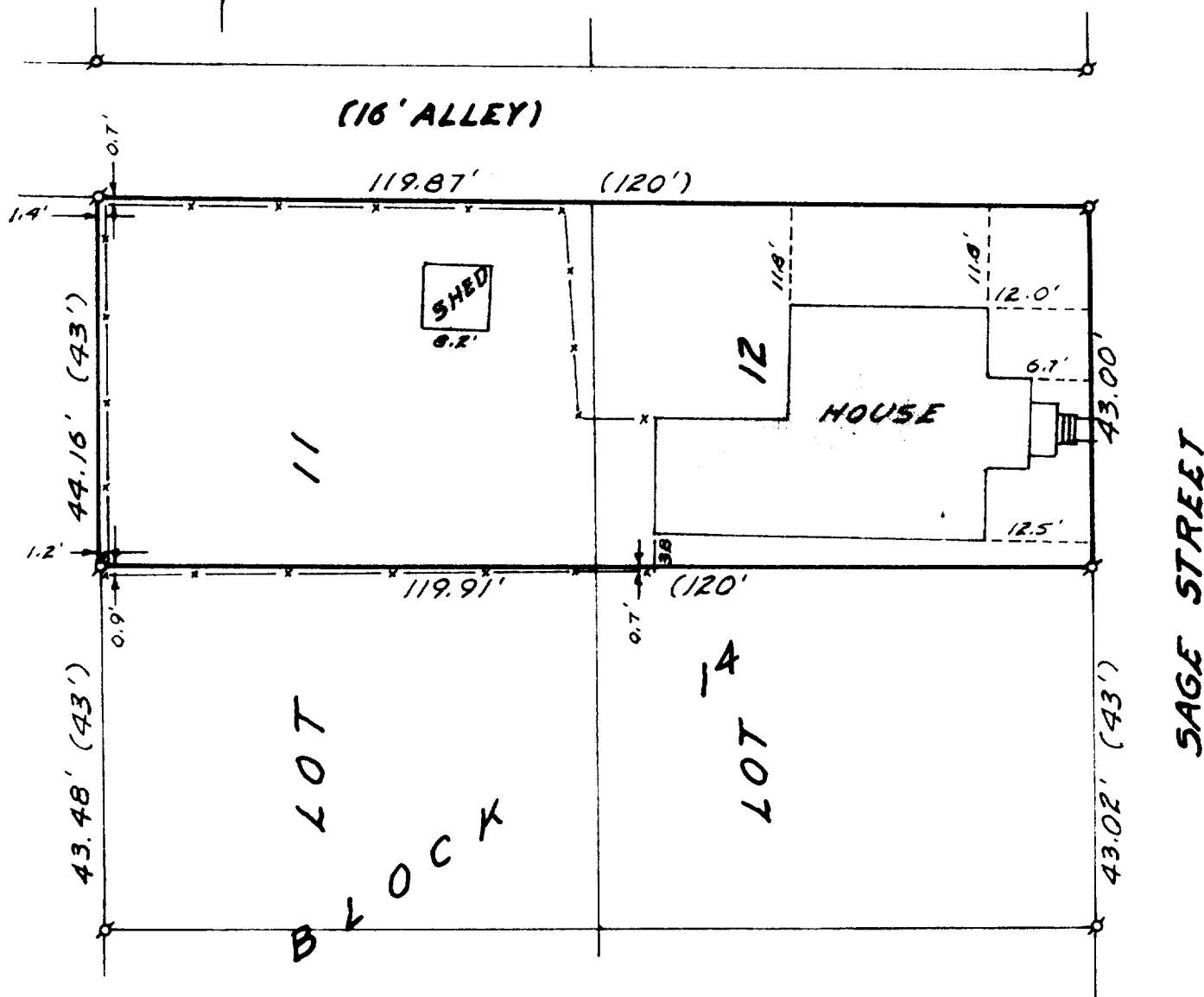

PLAT OF SURVEY OF

A PARCEL OF LAND DESCRIBED AS THE NORTH
43 FEET OF LOTS 11 AND 12, BLOCK 14,
ORIGINAL PLAT OF THE VILLAGE, NOW CITY
OF LAKE GENEVA, WALWORTH COUNTY, WIS.

ORDERED BY: JOHN NELSON
420 SAGE STREET
LAKE GENEVA, WI. 53147



SCALE: 1"=20'

LEGEND
o IRON PIPE FOUND
—x— FENCE
() AS RECORDED

I, HAROLD H. KOLB, DO HEREBY CERTIFY
THAT I HAVE SURVEYED THE PROPERTY
HEREON DESCRIBED ACCORDING TO THE
OFFICIAL RECORDS, AND THAT THE PLAT
HEREON IS A CORRECT REPRESENTATION
OF THE LOT LINES AND THE PRINCIPLE
LINES OF THE IMPROVEMENTS THEREON,
TO THE BEST OF MY KNOWLEDGE AND
BELIEF.

Harold H. Kolb

WISCONSIN REGISTERED LAND SURVEYOR, S-
DATE MAY 27, 1982